

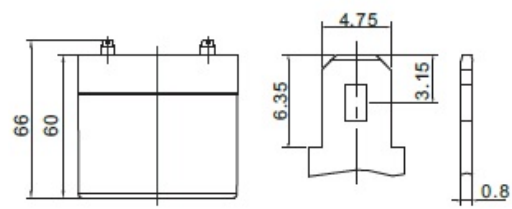

Nominal voltage	12 V	
Nominal capacity	3,4 Ah @ C20 to 1,75 V/cell	
Dimensions	Length	134 mm
	Width	67 mm
	Height / Total height	60 / 66 mm
Weight	~ 1,3 kg	
Technology	VRLA (Valve Regulated Lead Acid) AGM (Absorbent Glass Mat)	
Design life time	6-9 years (standby use)	
Internal resistance	~ 54,0 mΩ (full charged)	
Operating temperature range	Discharge	-20°C ~ +60°C
	Charge	0°C ~ +50°C
	Storage	-20°C ~ +60°C
Maximum discharge current	32 A (5 sec.)	
Short circuit current	166 A	
Recommended maximum charging current	0,96 A	
Charging voltage	Standby use	13,7 ~ 13,9 VDC
	Cycle use	14,6 ~ 14,8 VDC
Self discharge	Monthly is less than 3% at 25°C	
Container material	ABS UL94HB (optional UL94-V0)	
Terminal types	fast-on 4,8 mm	

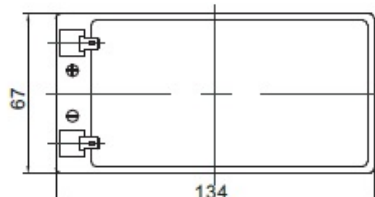
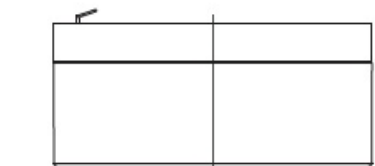

CONSTANT CURRENT DISCHARGE CHARACTERISTICS (A at 25°C)

Napięcie / czas	5 min	10 min	15 min	30 min	1 h	2 h	3 h	4 h	5 h	8 h	10 h	20 h
9.6 V	12,687	8,274	6,104	3,533	2,041	1,204	0,875	0,697	0,589	0,393	0,320	0,173
10.0 V	12,229	8,028	5,944	3,455	2,003	1,187	0,864	0,688	0,582	0,389	0,317	0,171
10.2 V	11,633	7,704	5,734	3,352	1,953	1,163	0,848	0,677	0,573	0,384	0,313	0,170
10.5 V	10,867	7,286	5,460	3,218	1,887	1,132	0,828	0,662	0,561	0,377	0,308	0,168
10.8 V	9,901	6,751	5,108	3,044	1,801	1,091	0,801	0,641	0,545	0,368	0,301	0,164
11.1 V	8,713	6,082	4,663	2,822	1,691	1,038	0,765	0,615	0,524	0,355	0,291	0,160

CONSTANT POWER DISCHARGE CHARACTERISTICS (W at 25°C)

Napięcie / czas	5 min	10 min	15 min	30 min	1 h	2 h	3 h	4 h	5 h	8 h	10 h	20 h
9.6 V	131,03	85,65	64,99	39,08	23,24	13,90	10,18	8,15	6,91	4,68	3,83	2,00
10.0 V	129,64	85,31	64,62	38,79	23,05	13,80	10,11	8,09	6,86	4,64	3,81	1,99
10.2 V	124,70	82,79	62,88	37,85	22,56	13,57	9,95	7,97	6,77	4,59	3,76	1,97
10.5 V	118,59	79,70	60,75	36,71	21,90	13,27	9,75	7,82	6,65	4,51	3,70	1,94
10.8 V	109,93	75,14	57,63	35,07	21,01	12,85	9,47	7,61	6,49	4,41	3,62	1,90
11.1 V	98,46	68,90	53,36	32,84	19,86	12,29	9,09	7,33	6,26	4,27	3,51	1,86

ACCORDING WITH:

PN-EN 60896-21:2007	ISO 9001
PN-EN 60896-22:2007	ISO 14001
PN-EN 61056-1:2013	
PN-EN 61056-2:2013	
PN-E-83016:1999	

EFFECT OF TEMPERATURE ON LONG TERM LIFE

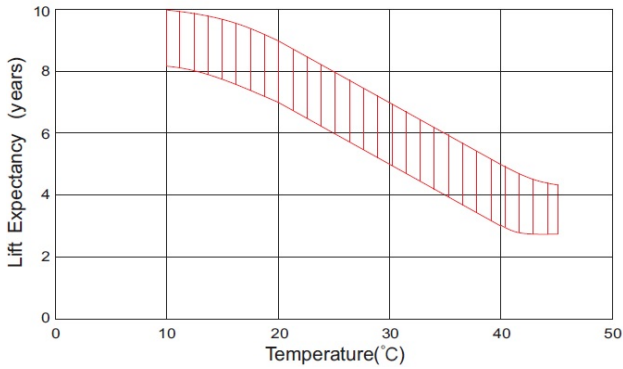

CYCLE LIFE IN RELATION TO DEPTH OF DISCHARGE

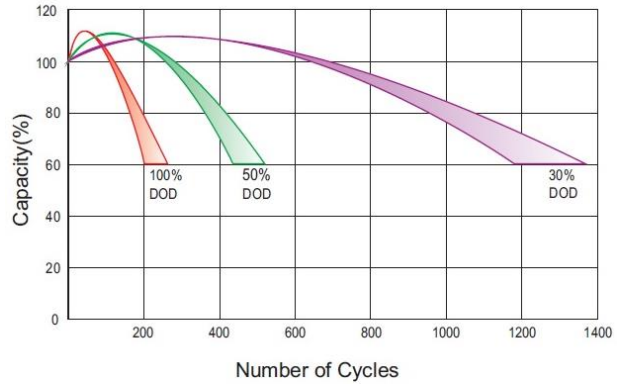

DISCHARGE CHARACTERISTICS

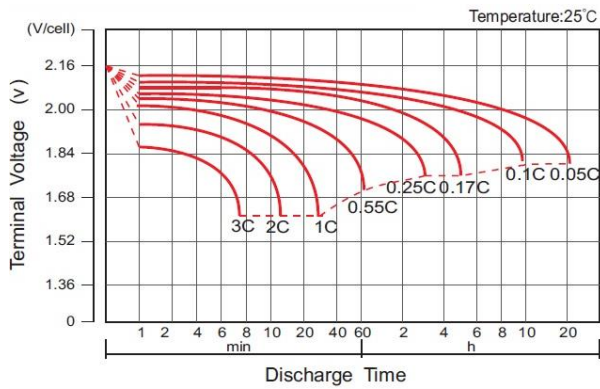

CHARGE CHARACTERISTIC FOR STANDBY USE

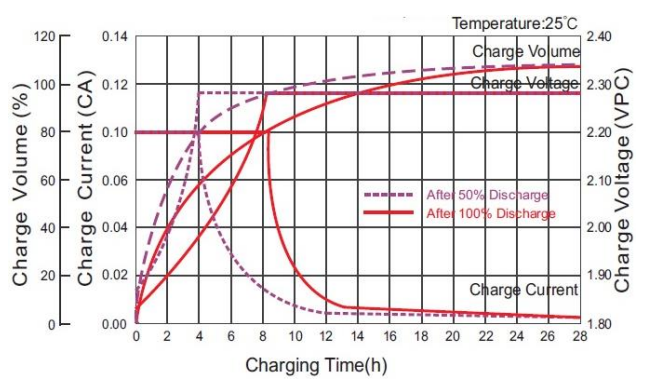

RELATIONSHIP BETWEEN CHARGING VOLTAGE AND TEMPERATURE

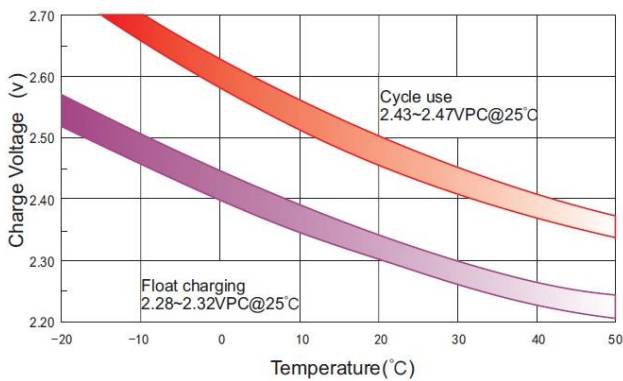

STORAGE CHARACTERISTICS

