

NEO10R

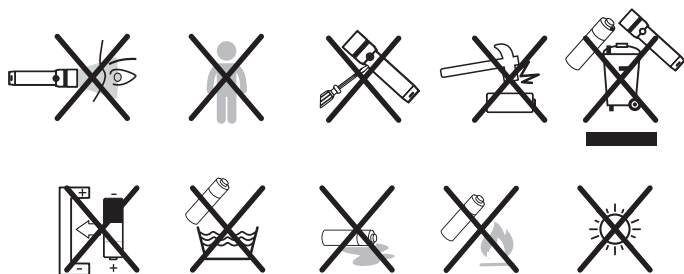

Ledlenser GmbH & Co. KG

Kronenstr. 5-7 • 42699 Solingen • Germany
Phone +49 212/5948-0 Fax +49 212/5948-200
info@ledlenser.com

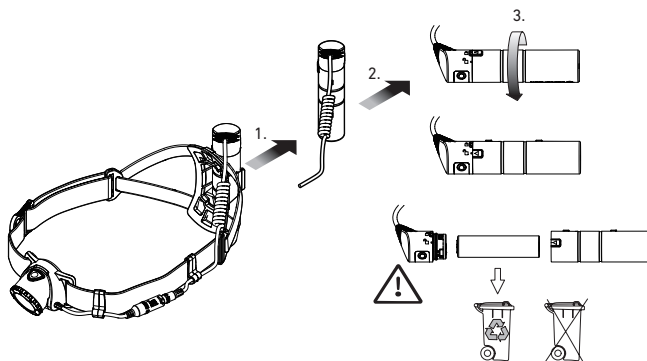
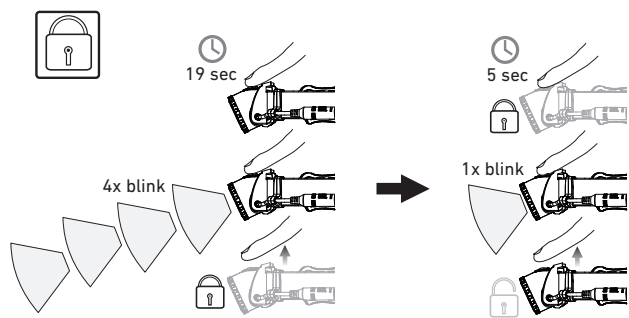
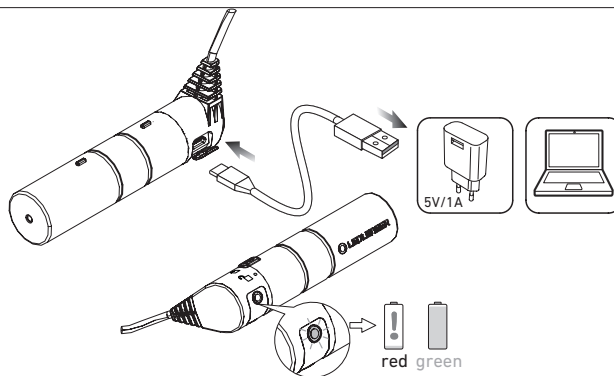
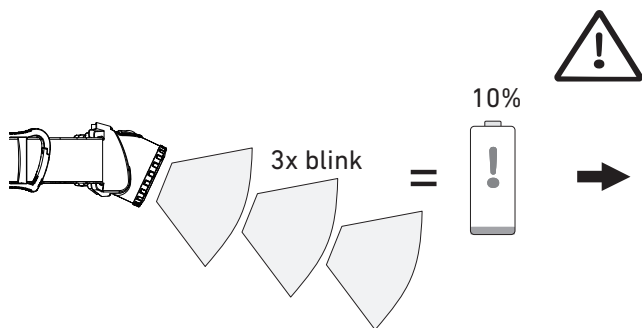
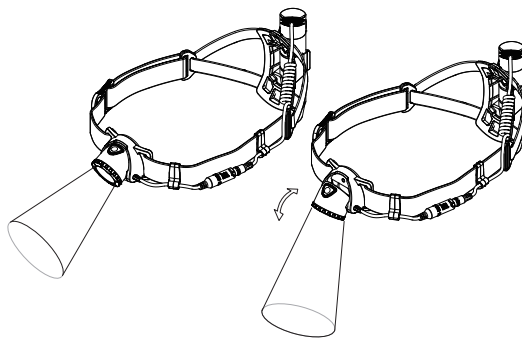
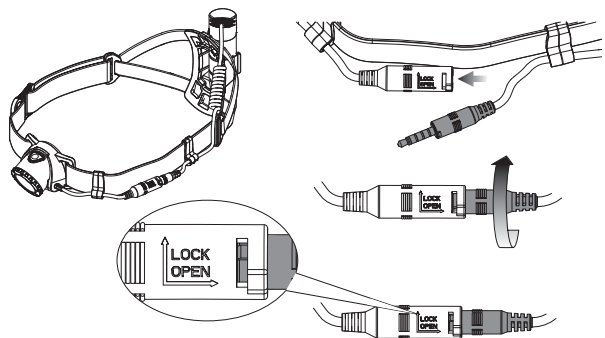
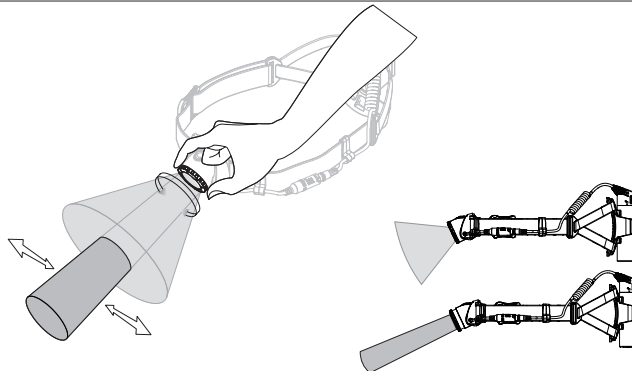
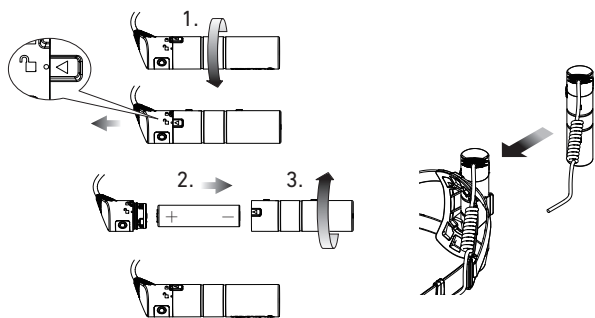
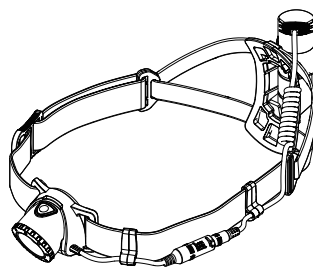
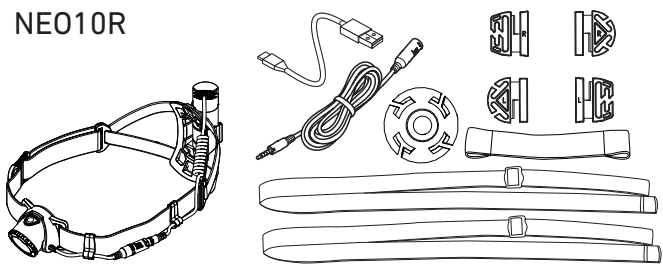

www.ledlenser.com



NEO10R_V.01
28.11.2017
1J12A0199

Mode 1

Mode 1 operation sequence:

- 10 sec
- 1x blink
- 1x
- +1x
- +1x
- +1x
- off

Graph: light output vs run time

Mode 2

The diagram illustrates the Mode 2 operation sequence:

- 13 sec**: Initial light output duration.
- 2x blink**: Two light pulses, each lasting 13 seconds.
- 1x**: One light pulse.
- +1x**: One light pulse.
- +1x**: One light pulse.
- +1x**: One light pulse.
- off**: The light output is turned off.

A graph shows **light output** on the y-axis and **run time** on the x-axis. The graph indicates a series of pulses, with the first pulse lasting 13 seconds, followed by two blinks, and then four more pulses, each lasting 13 seconds, before the output turns off.

Mode 3

The diagram illustrates the Mode 3 operation sequence. It begins with a 16-second light output, followed by a 3x blink sequence. The sequence then transitions to a 1x light output, which is followed by a +1x light output, and finally an off state. A graph shows the light output (y-axis) versus run time (x-axis), indicating a constant light output followed by a gradual decrease to zero.

