

RECHARGEABLE SEALED LEAD ACID BATTERY

SPECIFICATION

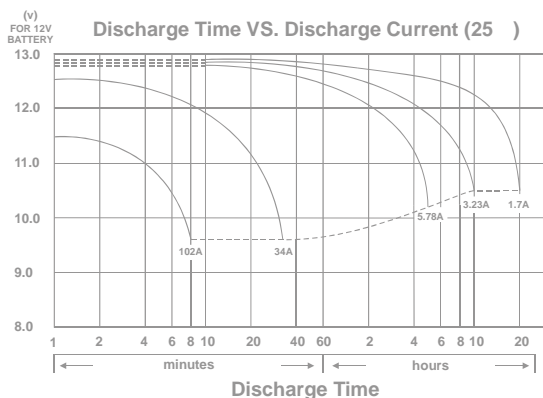
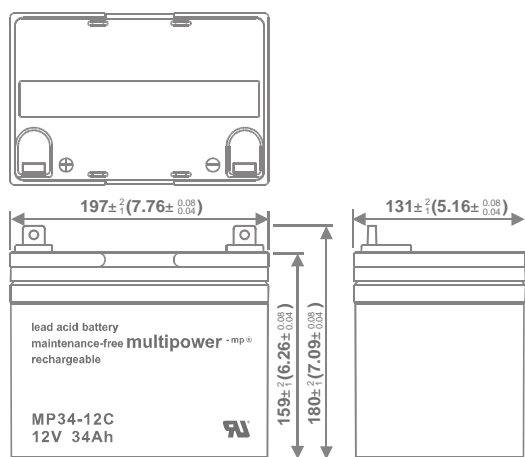
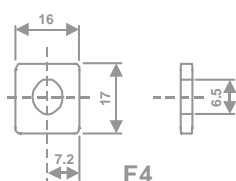

MP34-12C

Nominal Voltage(V) 12V

Nominal Capacity

| | | |
|--------------|-------------------|---------|
| 20 hour rate | (1.7A to 10.50V) | 34Ah |
| 10 hour rate | (3.23A to 10.50V) | 32.3Ah |
| 5 hour rate | (5.78A to 10.20V) | 28.9Ah |
| 1 C | (34A to 9.60V) | 19.27Ah |
| 3 C | (102A to 9.60V) | 13.6Ah |

Weight Approx. 10.5kg(23.1Lbs.)

Internal Resistance (at 1KHz) Approx. 9 mΩ

Maximum Discharge Current for 5 seconds: 510A

Charging Methods at 25 (77 °C)

Cycle use:

Charging Voltage 14.4 to 15.0V

Coefficient -5.0mV/°C/cell

Maximum Charging Current: 10.2A

Standby use:

Float Charging Voltage 13.50 to 13.80V

Coefficient -3.0mV/°C/cell

Operating Temperature Range

Charge -15 (5 °F) to 40 (104 °F)

Discharge -15 (5 °F) to 50 (122 °F)

Storage -15 (5 °F) to 40 (104 °F)

Charge Retention (shelf life) at 20 (68 °F)

1 month 92%

3 month 90%

6 month 80%

Case Material ABS
(UL94 HB flame retardant case / cover)

Terminal F4

CHARACTERISTIC & PERFORMANCE DATA

Effect of Temperature on Capacity 25 (77)

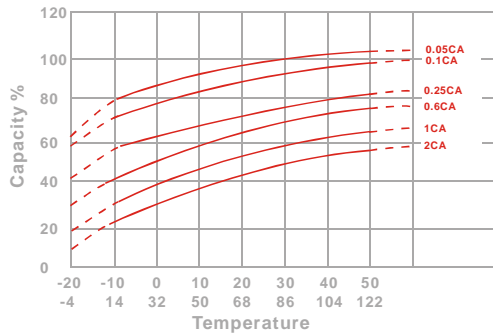

Trickle (or float) Service Life

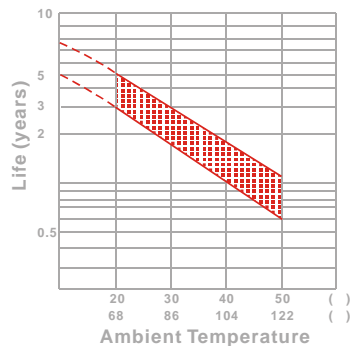

Capacity Retention Characteristic

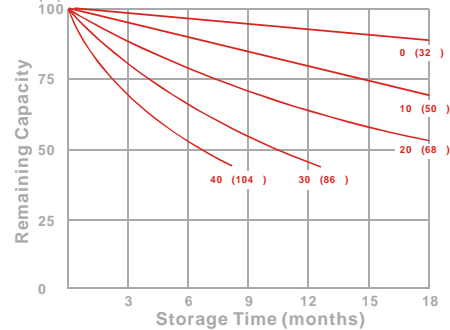

Cycle Service Life

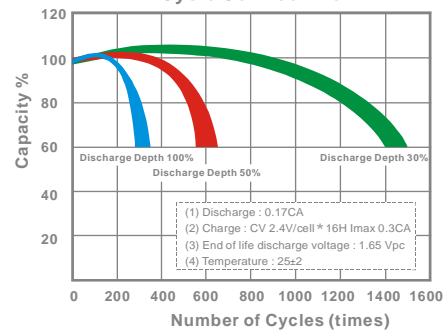

- PERFORMANCE DATA

Discharge Rates in Watts to Various End Voltages at 25 (77)

| End Voltage | | 1.85V | 1.80V | 1.75V | 1.70V | 1.67V | 1.65V | 1.60V |
|-------------|-----|-------|-------|-------|-------|-------|-------|-------|
| Time | | | | | | | | |
| 5 | min | 725 | 972 | 1159 | 1276 | 1317 | 1359 | 1413 |
| 10 | min | 511 | 669 | 788 | 862 | 888 | 915 | 950 |
| 15 | min | 413 | 535 | 625 | 682 | 699 | 720 | 746 |
| 30 | min | 225 | 291 | 340 | 371 | 380 | 392 | 406 |
| 60 | min | 213 | 226 | 235 | 240 | 242 | 245 | 247 |
| 120 | min | 136 | 143 | 147 | 150 | 151 | 153 | 154 |
| 180 | min | 92.1 | 97.8 | 102 | 104 | 105 | 106 | 107 |
| 240 | min | 74.0 | 78.6 | 81.6 | 83.4 | 84.3 | 85.1 | 85.8 |
| 300 | min | 63.1 | 67.1 | 69.6 | 71.2 | 71.8 | 72.6 | 73.2 |
| 600 | min | 37.3 | 39.7 | 41.2 | 42.1 | 42.5 | 42.9 | 43.3 |
| 1200 | min | 19.6 | 20.8 | 21.6 | 22.1 | 22.3 | 22.5 | 22.7 |

- Discharge Rates in Amperes to Various End Voltages at 25 (77)

| End Voltage | | 1.85V | 1.80V | 1.75V | 1.70V | 1.67V | 1.65V | 1.60V |
|-------------|-----|-------|-------|-------|-------|-------|-------|-------|
| Time | | | | | | | | |
| 5 | min | 86.9 | 107 | 121 | 129 | 132 | 136 | 140 |
| 10 | min | 60.3 | 70.0 | 76.0 | 80.2 | 82.0 | 84.5 | 87.5 |
| 15 | min | 50.2 | 57.4 | 62.1 | 64.8 | 65.6 | 66.4 | 67.8 |
| 30 | min | 29.0 | 32.8 | 34.4 | 35.7 | 36.1 | 36.6 | 37.1 |
| 60 | min | 17.3 | 18.6 | 19.5 | 20.2 | 20.4 | 20.7 | 21.0 |
| 120 | min | 10.6 | 11.4 | 11.9 | 12.3 | 12.4 | 12.6 | 12.8 |
| 180 | min | 7.86 | 8.37 | 8.73 | 8.99 | 9.06 | 9.14 | 9.27 |
| 240 | min | 5.91 | 6.35 | 6.73 | 6.92 | 6.97 | 7.04 | 7.15 |
| 300 | min | 5.31 | 5.59 | 5.75 | 5.88 | 5.93 | 5.99 | 6.07 |
| 600 | min | 3.10 | 3.22 | 3.32 | 3.41 | 3.44 | 3.47 | 3.51 |
| 1200 | min | 1.58 | 1.67 | 1.73 | 1.77 | 1.78 | 1.80 | 1.82 |

All data on the spec. sheet is an average value:

The tolerance range : X<6min(+15%~-15%), 6min X<10min(+12%~-12%),10min X < 60min(+8%~-8%), X 60min(+5%~-5%)