

RECHARGEABLE SEALED LEAD ACID BATTERY

SPECIFICATION



MP26-12C

Nominal Voltage(V) 12V

Nominal Capacity

20 hour rate	(1.3A to 10.50V)	26Ah
10 hour rate	(2.47A to 10.50V)	24.7Ah
5 hour rate	(4.42A to 10.20V)	22.1Ah
1 C	(26A to 9.60V)	14.73Ah
3 C	(78A to 9.60V)	10.4Ah

Weight Approx. 9.3kg(20.46Lbs.)

Internal Resistance (at 1KHz) Approx. 11 mΩ

Maximum Discharge Current for

5 seconds: 390A

Charging Methods at 25 (77)

Cycle use:

Charging Voltage 14.7 to 14.8V

Coefficient -5.0mV/ /cell

Maximum Charging Current: 7.8A

Standby use:

Float Charging Voltage 13.5 to 13.8V

Coefficient -3.0mV/ /cell

Operating Temperature Range

Charge -15 (5) to 40 (104)

Discharge -15 (5) to 50 (122)

Storage -15 (5) to 40 (104)

Charge Retention (shelf life) at 20 (68)

1 month 92%

3 month 90%

6 month 80%

Case Material

ABS

(UL94 HB flame retardant case / cover)

Terminal

F3

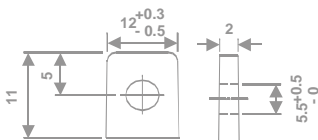

F3 (M5 Bolts)

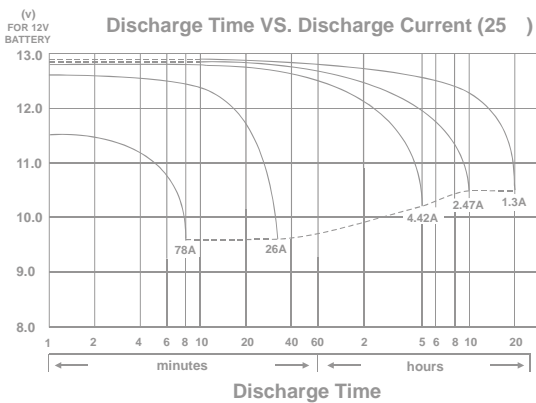
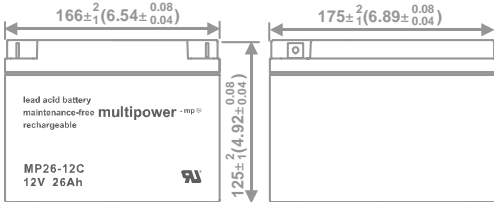
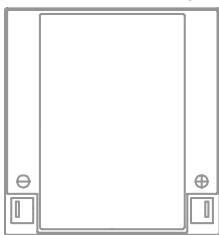

CHARACTERISTIC & PERFORMANCE DATA

Effect of Temperature on Capacity 25 (77 °)

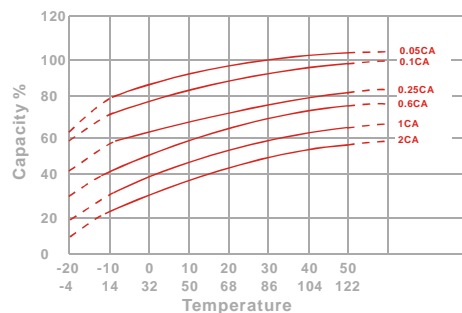

Capacity Retention Characteristic

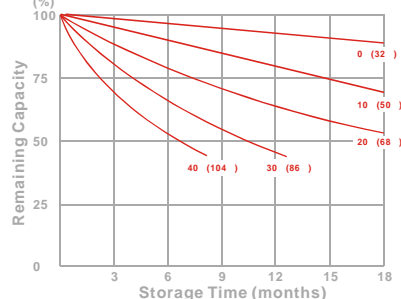

Trickle (or float) Service Life

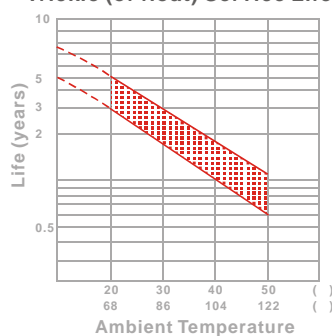

Cycle Service Life

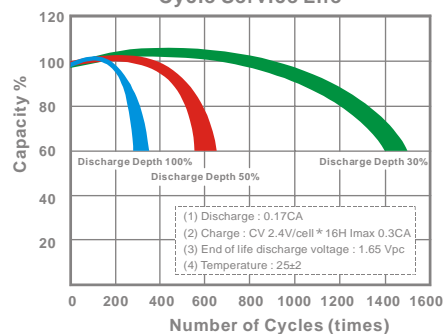

- PERFORMANCE DATA

Discharge Rates in Watts to Various End Voltages at 25 (77 °)

End Voltage		1.85V	1.80V	1.75V	1.70V	1.67V	1.65V	1.60V
Time								
5	min	836	927	994	1065	1098	1128	1196
10	min	617	659	695	727	743	760	788
15	min	443	485	513	536	548	559	579
30	min	238	257	274	286	291	296	302
60	min	169	179	187	193	195	197	199
120	min	110	115	118	121	122	123	124
180	min	75.3	77.5	78.6	79.7	80.2	80.8	81.2
240	min	61.1	62.6	63.4	64.2	64.5	64.9	65.2
300	min	51.6	51.9	52.9	53.7	54.1	54.3	54.6
600	min	30.1	30.9	31.5	31.9	32.1	32.3	32.5
1200	min	15.5	16.0	16.4	16.7	16.8	16.9	17.0

- Discharge Rates in Amperes to Various End Voltages at 25 (77 °)

End Voltage		1.85V	1.80V	1.75V	1.70V	1.67V	1.65V	1.60V
Time								
5	min	73.8	85.2	94.8	102	105	107	110
10	min	53.9	60.2	63.3	66.2	68.3	70.2	72.6
15	min	38.4	43.8	47.1	49.8	51.5	52.1	53.3
30	min	22.2	24.6	25.9	27.2	27.9	28.4	29.4
60	min	14.9	15.7	16.2	16.6	16.8	17.0	17.2
120	min	9.16	9.43	9.62	9.83	9.92	10.0	10.1
180	min	6.38	6.56	6.65	6.75	6.79	6.84	6.91
240	min	5.21	5.36	5.49	5.60	5.63	5.68	5.74
300	min	4.43	4.54	4.63	4.70	4.72	4.74	4.77
600	min	2.47	2.55	2.62	2.67	2.69	2.72	2.75
1200	min	1.26	1.32	1.37	1.41	1.43	1.44	1.46

All data on the spec. sheet is an average value:

The tolerance range : X<6min(+15%~-15%), 6min X<10min(+12%~-12%), 10min X < 60min(+8%~-8%), X 60min(+5%~-5%)