

### Product features

- Maintenance free battery, no need for watering
- Front terminal design-easy access for faster installation (19"/23" racks) and maintenance
- Specific environmentally friendly formation process
- Analytical grade electrolyte
- Spill & leak proof construction
- Safety valves, integrated backfire protection
- Container and lid made from ABS (UL 94 V-0 version available on request)
- Low self-discharge
- Non dangerous good according to FAA und IATA classification
- Complies with the following standards: IEC 60896-21/22, EUROBAT



### Specification

Nominal voltage	12 V
Nominal power	330 Wpc (C <sub>15min</sub> @ 25°C / 77°F)
EUROBAT-Classification	Long Life
Operating temperature	-20°C to 60°C (-4°F to 140°F) Charging: 0°C to 50°C (32°F to 122°F)
Grid alloy	Lead-calcium-tin
Electrode design	Flat grid, pasted
Separator	<b>Absorbent Glass Mat (AGM)</b>
Active material	High purity lead and lead dioxide
Container and lid	ABS UL 94 HB (V-0 version on request)
Charge voltage	Float charging: 2.275 Vpc @25°C (77°F) Cyclic use: 2.45 Vpc
Electrolyte	Maximum ripple: 0.05 C (A) Purified high grade sulfuric acid
Safety valve	EPDM rubber
Central degassing	Yes
Terminal	M8



## Physical data

Nominal voltage		12 V	
Nominal capacity		105 Ah (C <sub>10h</sub> @ 1.80 Vpc)	
Dimension (±2 mm/ ±0.08 inch)	Length	508 mm	20.0 inches
	Width	110 mm	4.33 inches
	Height	236 mm	9.29 inches
	Weight	32.5 kg	71.6 lbs.

## Electrical data

Capacity 20°C (68°F) to 1.7 Vpc	20 h	112.6 Ah
	10 h	108.0 Ah
	5 h	94.0 Ah
	1 h	59.9 Ah
	15 min	42.7 Ah
Internal resistance		6.5 mΩ
Impedance		-
Temperature correction factors	40°C (104°F)	102%
	20°C (68°F)	100%
	0°C (32°F)	85%
	-15°C (5°F)	65%
Self-discharge at 20°C (68°F) - capacity after	1 month storage	98%
	3 months storage	94%
	6 months storage	86%
Short circuit current	A @ 20°C (68°F)	-
Terminal	Standard	M8
	Optional	-
Charging voltage	Cyclic	2.45 Vpc
	Float charging	2.275 Vpc 25°C (77°F)

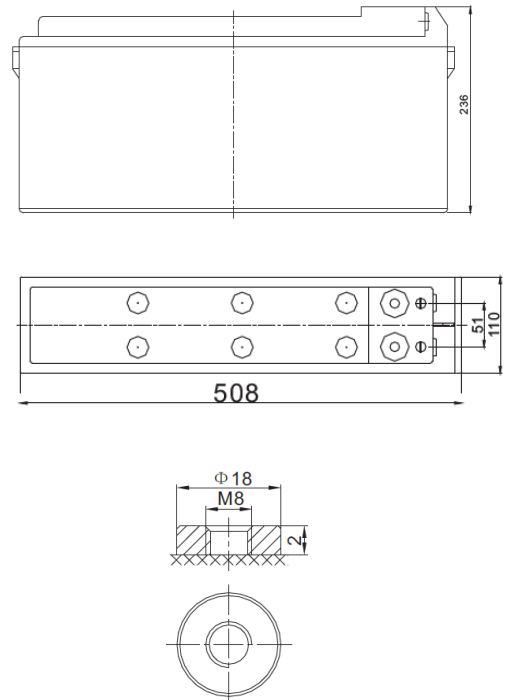

## Constant current discharge – A @ 25°C (77°F)

Uf Vpc	5 min	10 min	15 min	30 min	60 min	2 h	3 h	5 h	8 h	10 h	20 h
1.85	146.1	146.1	121.8	82.2	49.8	30.5	24.3	16.6	11.8	9.88	5.23
1.80	176.1	176.1	146.7	95.4	55.5	33.3	26.3	17.8	12.6	10.5	5.51
1.75	190.7	190.7	158.9	99.8	57.7	34.5	27.1	18.3	12.8	10.6	5.56
1.70	204.9	204.9	170.8	104.4	59.9	35.8	27.9	18.8	13.0	10.8	5.63
1.65	218.8	218.8	182.3	109.3	62.0	37.0	28.7	-	-	-	-
1.60	228.8	228.8	190.7	113.8	64.2	38.2	29.6	-	-	-	-

## Constant power discharge – Watt per cell @25°C (77°F)

Uf Vpc	5 min	10 min	15 min	30 min	60 min	2 h	3 h	5 h	8 h	10 h	20 h
1.85	274.5	274.5	228.8	157.0	96.4	59.3	47.3	32.6	23.3	19.6	10.4
1.80	326.2	326.2	271.8	180.5	106.9	64.4	51.0	34.9	24.7	20.7	10.9
1.75	348.4	348.4	290.3	187.0	110.5	66.4	52.4	35.7	25.1	21.0	11.0
1.70	369.0	369.0	307.5	193.6	114.0	68.5	53.8	36.5	25.4	21.2	11.1
1.65	388.2	388.2	323.5	200.6	117.1	70.5	55.0	-	-	-	-
1.60	400.1	400.1	333.4	206.7	120.6	72.4	56.6	-	-	-	-