

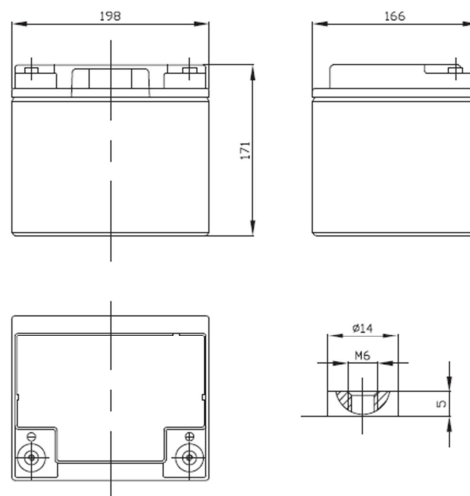

SBL 45-12i (12V 45Ah)

Design life time	10-12 years								
Technology	VRLA-AGM								
Voltage	12 V								
Capacity minimalna (10hr-rate to 1,8 V/cel at 25°C)	45 Ah								
Dimensions	<table> <tr> <td>Length</td><td>198 mm</td></tr> <tr> <td>Width</td><td>166 mm</td></tr> <tr> <td>High</td><td>171 mm</td></tr> <tr> <td>Total high</td><td>171 mm</td></tr> </table>	Length	198 mm	Width	166 mm	High	171 mm	Total high	171 mm
Length	198 mm								
Width	166 mm								
High	171 mm								
Total high	171 mm								
Weight	~ 13,5 kg								
Internal resistance – full charged battery at 25°C	~ 8 mΩ								
Temp. range	<table> <tr> <td>Discharge</td><td>- 20°C ~ + 60°C</td></tr> <tr> <td>Charge</td><td>- 0°C ~ + 50°C</td></tr> <tr> <td>storage</td><td>- 20°C ~ + 60°C</td></tr> </table>	Discharge	- 20°C ~ + 60°C	Charge	- 0°C ~ + 50°C	storage	- 20°C ~ + 60°C		
Discharge	- 20°C ~ + 60°C								
Charge	- 0°C ~ + 50°C								
storage	- 20°C ~ + 60°C								
Battery case	ABS (UL-94HB)								



Effect of temperature on long term float life

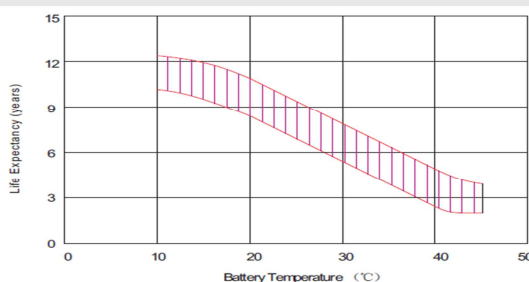

Storage characteristic

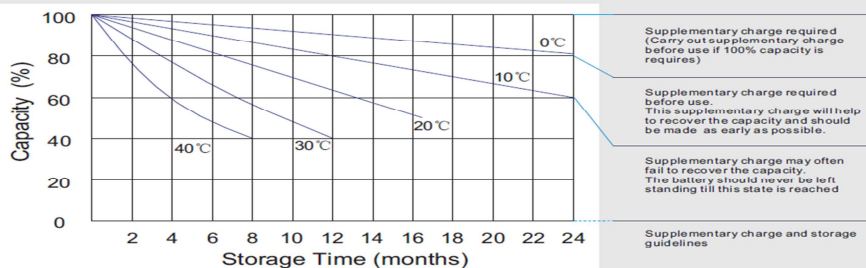

Charge characteristic Curve for standby use

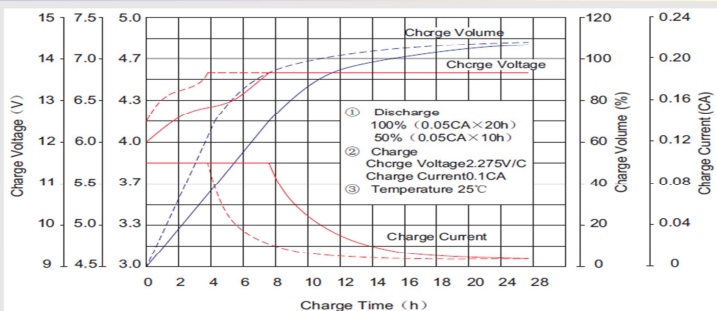

Discharge characteristic Curve

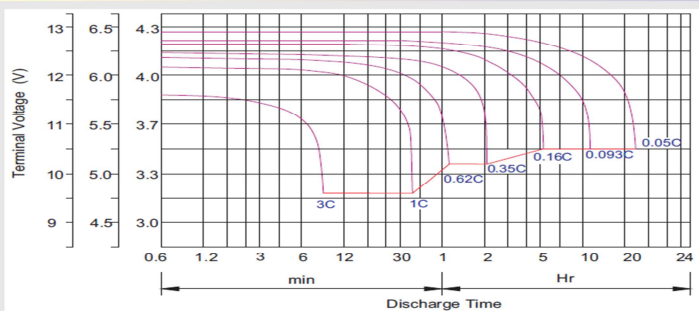

Constant Current Discharge Characteristics (A at 25°C)

napięcie/czas	5 min	10 min	15 min	30 min	1 h	2 h	3 h	4 h	5 h	8 h	10 h	20 h
9.6 V	150.8	111.0	86.54	52.74	29.25	17.49	12.08	10.01	8.424	5.754	4.773	2.547
10.0 V	146.4	105.6	84.76	51.83	29.12	17.36	12.03	9.960	8.374	5.707	4.727	2.500
10.2 V	142.1	101.9	83.43	50.87	28.85	17.23	11.94	9.913	8.325	5.661	4.681	2.454
10.5 V	127.6	94.03	79.44	50.48	28.58	17.10	11.89	9.821	8.226	5.614	4.635	2.408
10.8 V	115.2	85.74	73.23	49.62	27.90	16.79	11.57	9.589	8.077	5.520	4.589	2.361
11.1 V	98.32	76.63	65.68	46.46	26.51	16.05	11.06	9.126	7.730	5.286	4.451	2.222

Constant Power Discharge Characteristics (W at 25°C)

napięcie/czas	5 min	10 min	15 min	30 min	1 h	2 h	3 h	4 h	5 h	8 h	10 h	20 h
9.6 V	1591	1182	943.4	591.8	338.0	206.2	143.7	119.3	100.5	68.71	57.03	30.53
10.0 V	1559	1146	928.3	584.5	337.2	205.1	143.8	119.1	100.2	68.37	56.67	30.00
10.2 V	1542	1116	917.8	580.4	334.6	203.8	143.1	118.9	99.90	67.93	56.17	29.45
10.5 V	1403	1039	875.5	576.4	331.6	202.4	142.6	117.7	98.71	67.37	55.62	28.89
10.8 V	1278	957.8	809.2	567.1	325.5	199.8	138.7	115.1	96.93	66.24	55.07	28.34
11.1 V	1123	865.9	728.4	534.2	311.5	192.4	132.7	109.5	92.76	63.44	53.42	26.67